

FMS 90MM Pro 12 Blatt Alu Impeller EDF mit 4075-KV1500 Inrunner Brushless Motor (8S)

Art.Nr.: PA-FMS-DF002-Pro / EDF010

FMS 90MM Pro Metal EDF is made of die-casting CNC, and the stainless steel bushing injected in the fan blade effectively increases the strength and wear resistance of the blade. The built-in fan of the motor can reduce the heat of the motor to a low temperature. The design of the motor shaft is a through shaft, and there is no extra transfer. This design can ensure the concentricity of the motor shaft to achieve the effect. The total weight of the EDF is 560g (135g after removing the motor), which has rigidity and toughness, and can be used with confidence. The standard motor is a 4075 KV1500 inrunner brushless motor with a shaft diameter of 8mm, a shaft length of 31mm, and a power of 3500W.

Description:

Brand: FMS

Item: 90mm Pro 12 Blades Ducted Fan EDF

Motor: 4075 KV1500(8S)

Weight:

Usage: Suitable for RC Airplane, Fixed-wing

Aluminium Housing

Motor Features:

- * 4 poles 12 slots high torque motor design;
- * CNC processing steel billet, 6061-T6 aluminum heat sink, high-end and delicate appearance;
- * High-purity rigid coil, maximum efficiency, temperature resistance 200°C;
- * High-speed ABEC5 ultra-durable Japan (NMB) imported sealed bearings, low friction, low noise and high accuracy;
- * Customized special soft support balancing machine with high balance explosion-proof rotor, extremely low vibration;
- * 0.2 ultra-thin silicon steel sheet imported from Japan: excellent

performance, high magnetic permeability, high silicon content, good insulation and heat resistance;

* Built-in centrifugal fan reduces the temperature of the motor and improves the efficiency of the motor at the rear.

Contrast Test Data:

8S Comparision Test

FMS Metal EDF	29.6V	106A	Thrust: 4.8-5.0KG
Other Brand Metal EDF	29.6V	106A	Thrust: 4.3-4.6KG

Recommended Parts:

Battery: 8S 5500mAh 45C lipo

ESC: 120A brushless

Dimension:

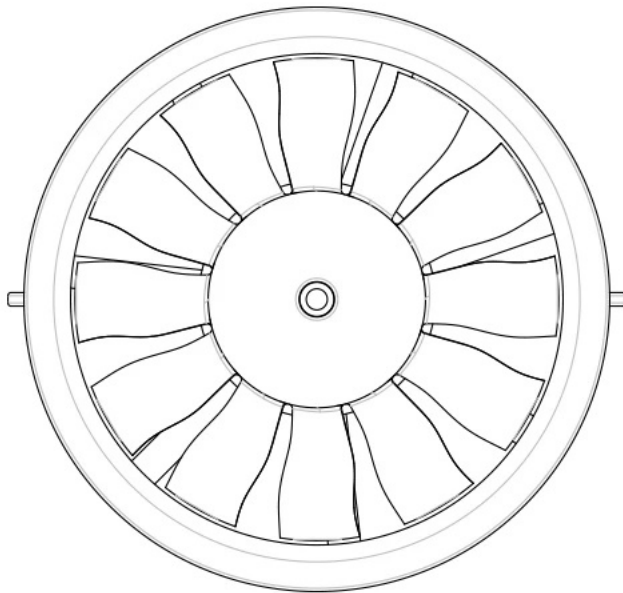
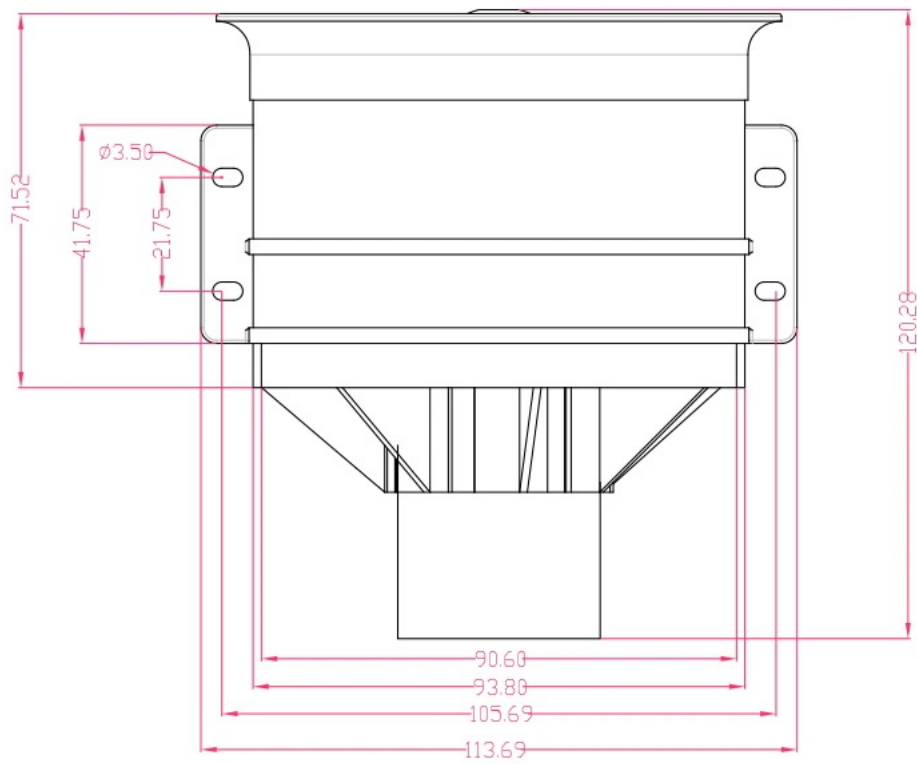

Package Included:

1x FMS 90MM Pro 12 Blades Metal Ducted Fan EDF With 4075-KV1500
Inrunner Brushless Motor



90mm Pro Metal EDF



90mm Pro 12BLADES

90mm Ducted Fan 12 Blades with
inner-running motor 8S

FMS is proud to announce its revolutionary 90mm aluminum-alloy EDF unit. Featuring a CNC processed duct system with highly efficient fan blades, the 4075 1500KV motor provides a massive peak thrust of 5000 grams!