

ELECTRO SAILPLANE

Olympic



Manufactured by:

TOPMODEL CZ

679 05 HABRŮVKA 100 - CZECH REPUBLIC

www.topmodelcz.cz

e-mail: info@topmodelcz.cz

Order N°: 02084

Radio system you'll need :



1310mm

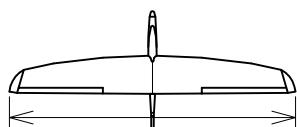

2300mm

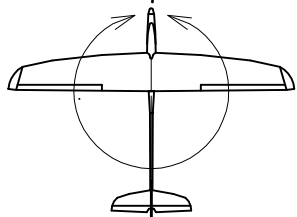

38,5dm²
36,4-44g/dm²



1,4 - 1,7kg

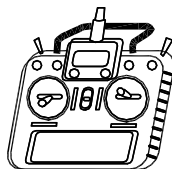

5channel
with
6 servos



XPower XC 3514/12

Axi 2814/12

XPower XC3223/10

Mega ACn22/20/3E

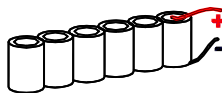

2S-3S Lixx 2-3Ah



MH 32

*Není-li uvedeno jinak, všechny
neoznačené míry jsou v milimetrech
UNLES STATED, ALL DIMENSIONS
ARE IN MILIMETERS*

Olympic

GB - USA Parts list

Part #	Part name	Material, dimensions	Loose	In bag
	building instruction		01	-
1	fuselage	fibreglass	01	-
1-1	engine mount	fibreglass 3 mm	-	01
1-2	servo tray V-tail	plywood 4 x 53 x 47 mm	-	01
1-3	link support	balsa 5 x 10 x 50 mm	-	01
2	wing	foam core - balsa	02	-
2-1	aileron	foam core - balsa	02	-
2-11	flap	foam core - balsa	02	-
24	wing joiner	steel Ø 6 x 170 mm	-	01
2-2	wing fixing screw	nylon screw M 4 x 30 mm	-	02
2-21	centering pin	fibreglass Ø 3 x 30 mm	-	01
2-25	wing pin	beech dowel Ø 4 x 40 mm	-	02
2-3	captive nut	aluminium M4	-	02
2-31	nut mount	plywood 3 x 23 x 53 mm	-	01
2-4	servo mount	polyurethan	-	04 + 04
2-41	wing servo cover	ABS plastic	-	04
2-5	aileron-flap pushrod	piano wire M2	-	04
2-6	clevis	MPJ 2110	-	04
2-8	aileron horn	fibreglass plate 1 mm	-	02
2-81	flap horn	fibreglass plate 1 mm	-	02
3	V-tail	balsa assembly	01	-
3-2	V-tail screw	steel M3 x 25 mm	-	01
3-21	screw bushing	brass Ø4/3mm L = 12,5 mm	-	01
3-3	screw nut	aluminium M3	-	01
3-31	nut mount	plywood 3 x 12 x 22 mm	-	01
3-5	V-tail link	bowden Ø2 mm L=820mm, piano wire Ø0,8 mm L= 920mm	02+02	-
3-6	threaded link	MPJ 2758	-	02
3-8	horn	fibreglass plate 1 mm	-	02
6	canopy	fibreglass	01	-
6-2	canopy fixing	fibreglass Ø2 x 180 mm	-	01
6-21	mount	plywood 1 x 6 x 12 mm	-	02
7	stickers		01	

RECOMMENDED RC EQUIPMENT:

Radio : 5 channel + 7 channel (receiver)
Servos : 2x HS 82MG (for flaps), 4x Topmodel PS1616 (for ailerons and V-tail)
Motor : Xpower XC 3514/12
Controller: 40 – 50A (JETI SPIN 44, Xreg 40 with switch BEC)
Spinner: ø 40/5 mm - order No.099T1559 (order No.0201559)
Prop: Aeronaut CAM Carbon 10/6“

ATTENTION:

This model construction kit is not a toy and is not suitable for children under the age of 14. Incorrect use of this material could cause material damage or person injury. You are fully responsible for your actions when you use this model.
Fly at a safe distance from occupied zones. Be sure that no one else is using the same frequency as you.

Olympic

Položka	Název dílu	Materiál, rozměr	Volně / ks	Balíček/ ks
	montážní návod		01	-
1	trup	laminát	01	-
1-1	motorová přepážka	sklotextit 3 mm	-	01
1-2	držák serva ocasních ploch	překližka 4 x 53 x 47 mm	-	01
1-3	držák bowdenů	B 5 x 10 x 50 mm	-	01
2	křídlo	polystyren-balsa	02	-
2-1	křídélko	polystyren-balsa	02	-
2-11	vztlaková klapka	polystyren-balsa	02	-
24	spojka křídla	ocel Ø 6 x 170 mm	-	01
2-2	uchycení křídla	šroub M 4 x 30 mm	-	02
2-21	aretační kolík	laminát Ø 3 x 30 mm	-	01
2-25	kolík křídla	buk Ø 4 x 40 mm	-	02
2-3	uchycení křídla	matice AL. M4	-	02
2-31	podložka matice	překližka 3 x 23 x 53	-	01
2-4	držák serva	polyuretan 13mm; 11mm	-	04 + 04
2-41	krytka serva	ABS folie	-	04
2-5	táhlo křídélka a klapky	ocel	-	04
2-6	koncovka táhla	MPJ 2110	-	04
2-8	páka křídélka	sklotextit 1 mm	-	02
2-81	páka klapky	sklotextit 1 mm	-	02
3	ocasní plochy	balsa konstrukční	01	-
3-2	šroub OP	M3 x 25	-	01
3-21	průchodka šroubu	MS Ø4/3mm L = 12,5	-	01
3-3	matice OP	AL M3	-	01
3-31	podložka matice	př. 3 x 12 x 22	-	01
3-5	táhlo OP	bowden Ø2 mm L=820mm, ocel drát Ø0,8 mm L= 920mm	02 + 02	-
3-6	koncovka táhla	MPJ 2758	-	02
3-8	páka	sklotextit 1 mm	-	02
6	kabina	laminát	01	-
6-2	uchycení kabiny	laminát Ø 2 x 180 mm	-	01
6-21	podložka	př. 1 x 6 x 12	-	02
7	obtisky		01	

DOPORUČENÉ PŘÍSLUŠENSTVÍ :

RC souprava : 5 kanál + 7 kanál přijímač

Serva : 2x HS 82MG (pro klapky), 4x Topmodel PS1616 (pro křídélka a ocasní plochy)

Motor : Xpower XC 3514/12

Regulátor: 40 – 50A (JETI SPIN 44, Xreg 40 se spínaným BEC)

Kužel: [099T1559](#) ([0201559](#))

Listy: Aeronaut CAM Cabon 10/6“

Manufactured by:

TOPMODEL CZ

679 05 HABRŮVKA 100 - CZECH REPUBLIC

www.topmodelcz.cz
e-mail:info@topmodelcz.cz

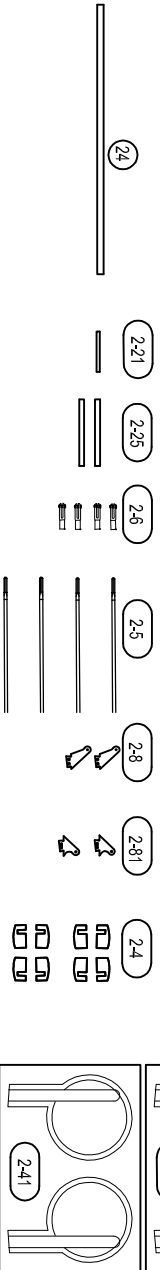
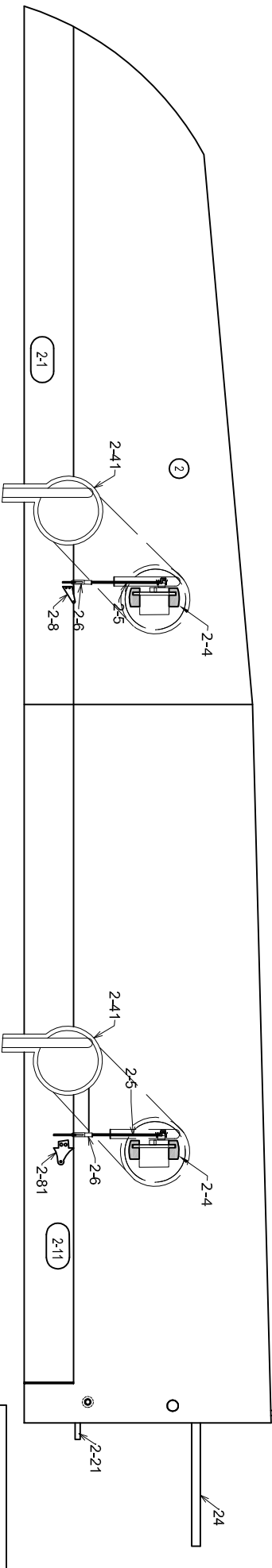
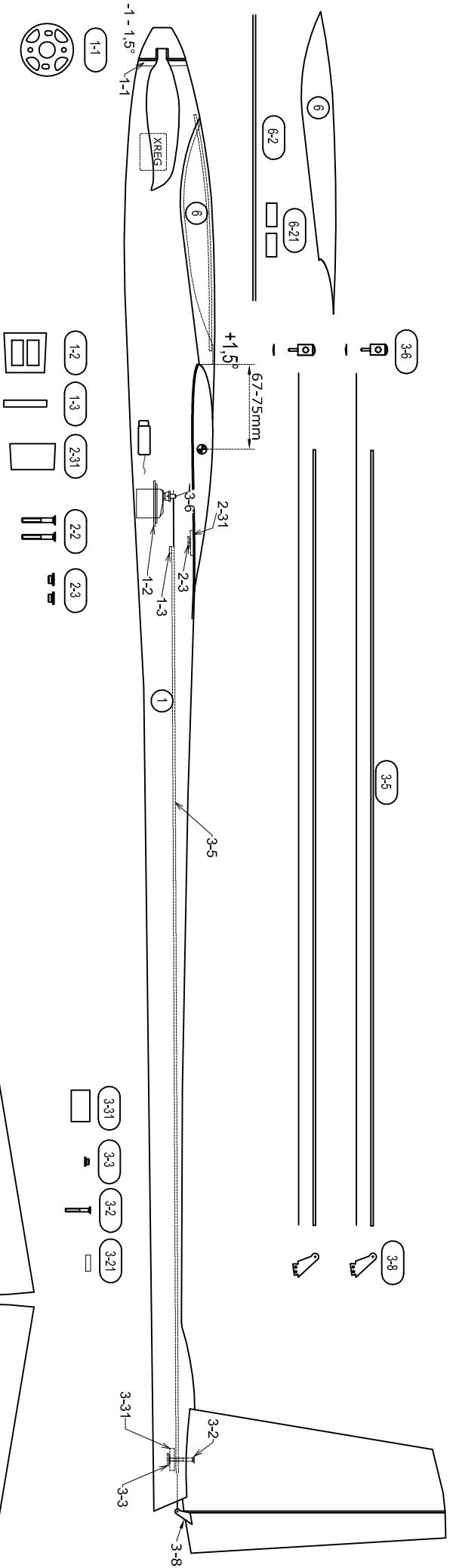

TOPMODEL CZ

© VII. 2009 TOPMODEL CZ Výkres není v měřítku - Not scale !!!

Olympiac

© VII. 2009 TOPMODEL CZ Manufactured by TOPMODEL CZ s.r.o. 679 05 HABRŮVKA 100 - Better made in the Czech Republic
 www.topmodelcz.cz e-mail: info@topmodelcz.cz

Olympic

Oracover®

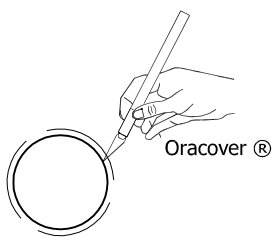

SPODNÍ STRANA
BOTTOM

②

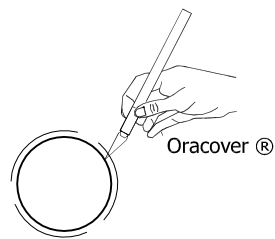

Oracover®

Oracover®

spodní + horní strana
bottom + top

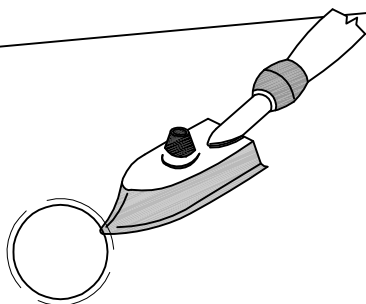

SPODNÍ STRANA
BOTTOM

②

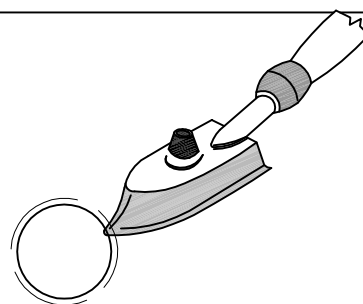

VRCHNÍ STRANA
TOP

krok 1.
step 1.

②

páska
tape

krok 2.
step 2.

páska 2
tape

2-1

1/2
1/2

2-25

krok 1.
step 1.

páska
tape

krok 2.
step 2.

páska 2
tape

SPODNÍ STRANA
BOTTOM

2-11

1/2
1/2

2-21

Olympic

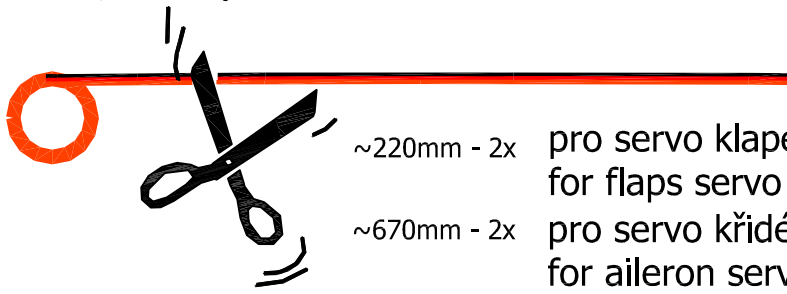

~220mm - 2x pro servo klapek
for flaps servo

~670mm - 2x pro servo křidélek
for aileron servo

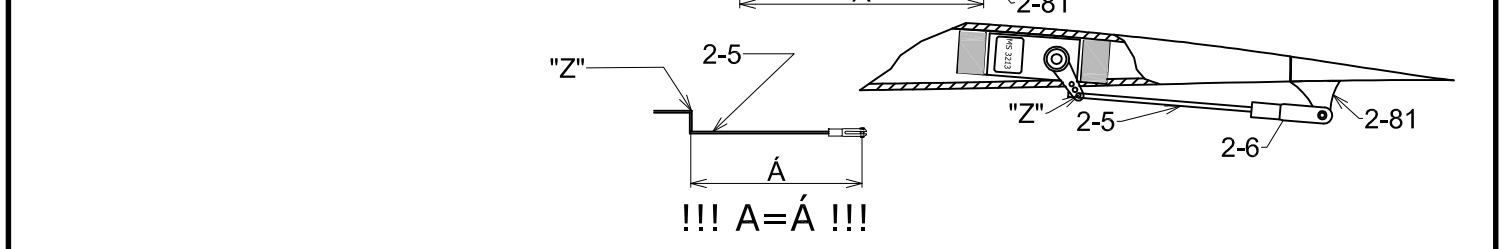
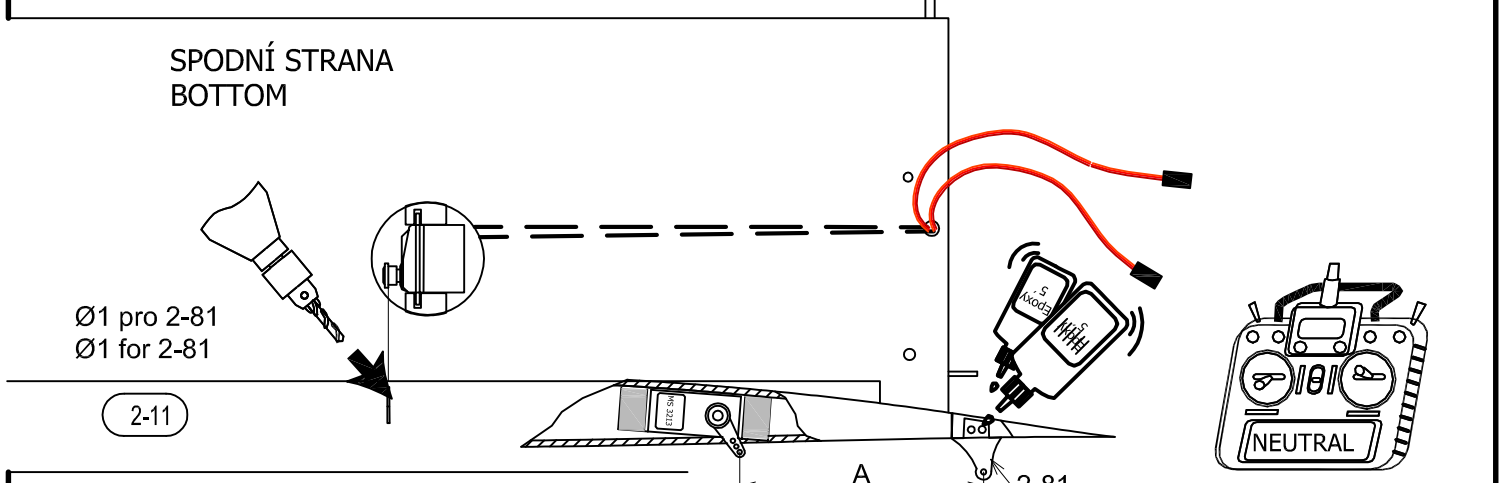
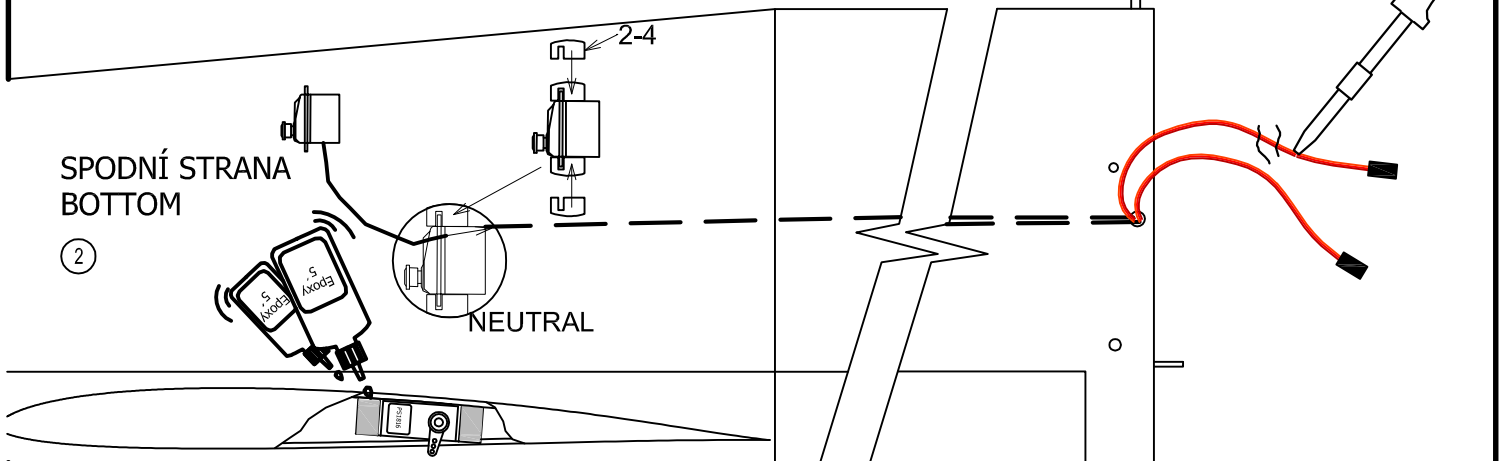
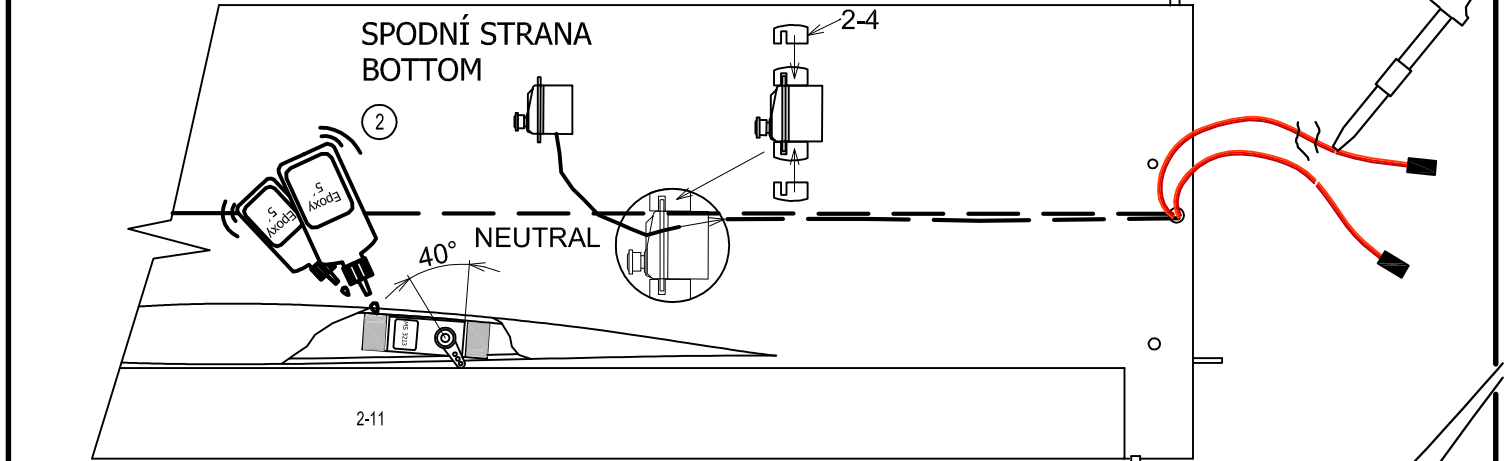

Olympic

SPODNÍ STRANA
BOTTOM

Ø1 pro 2-8
Ø1 for 2-8

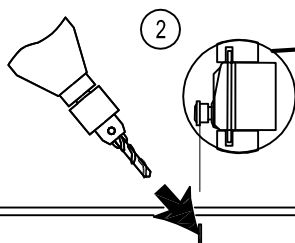

2-1

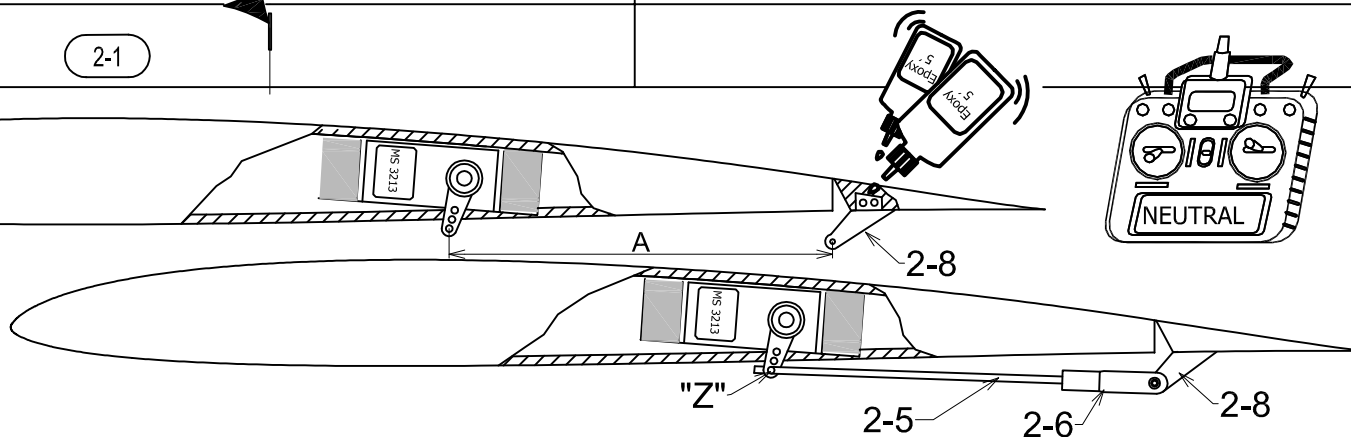
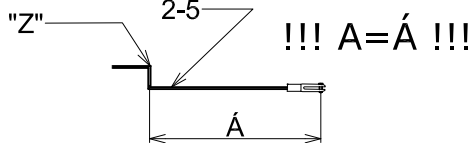

SPODNÍ STRANA
BOTTOM

2

kontaktní lepidlo (Chemopren)
dry-bond adhesive

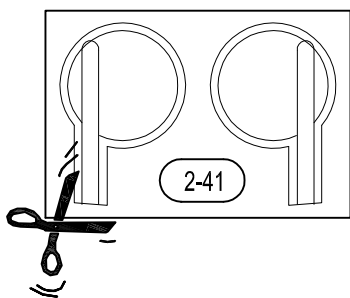

2-41

2-41

SPODNÍ STRANA
BOTTOM

2

kontaktní lepidlo (Chemopren)
dry-bond adhesive

2-41

Olympic

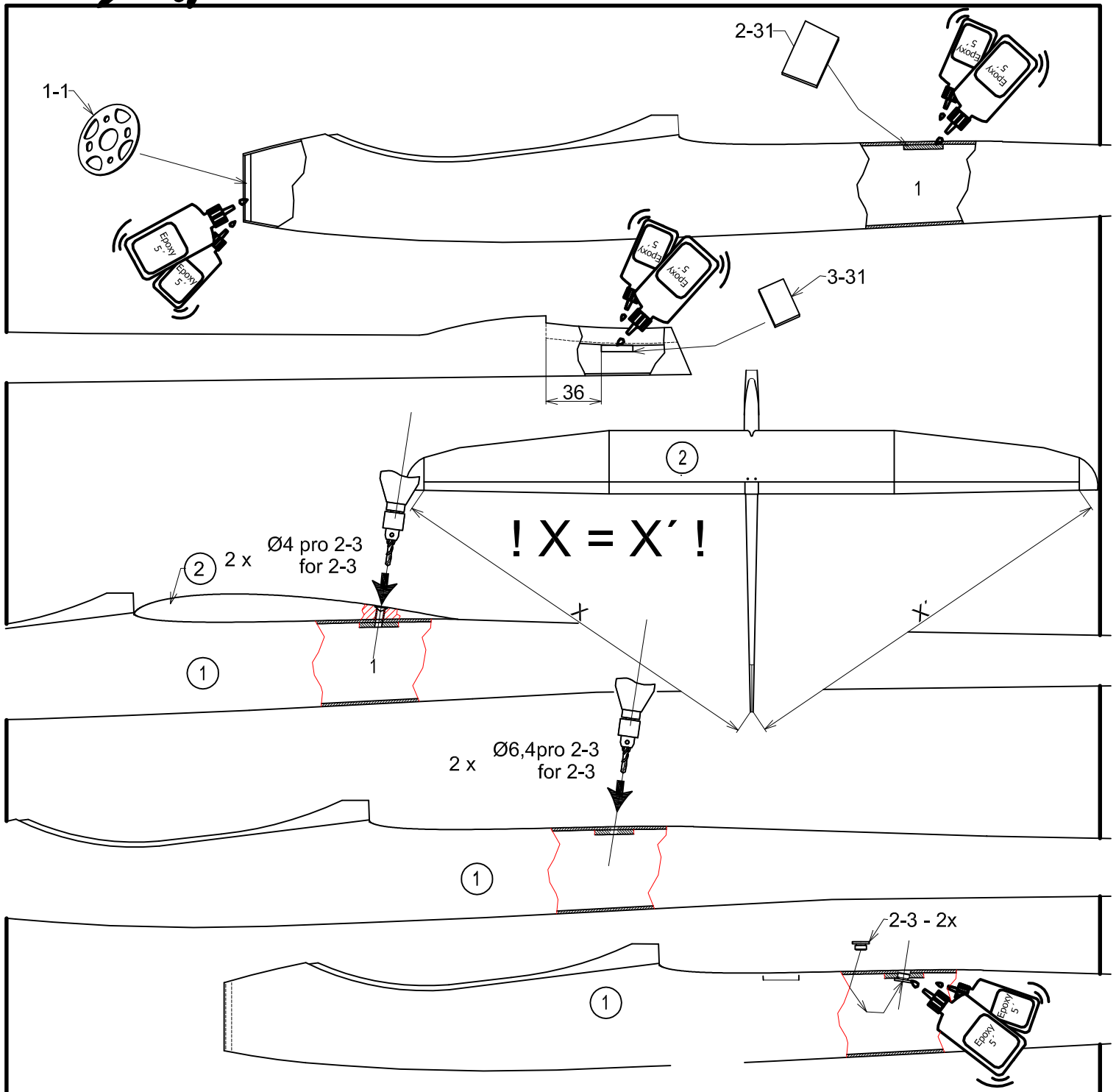

! X = X' !

3 levá i pravá polovina ocasních ploch
left side and right side of elevator

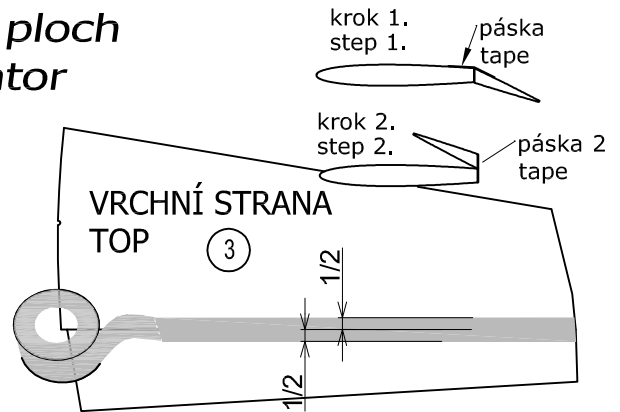
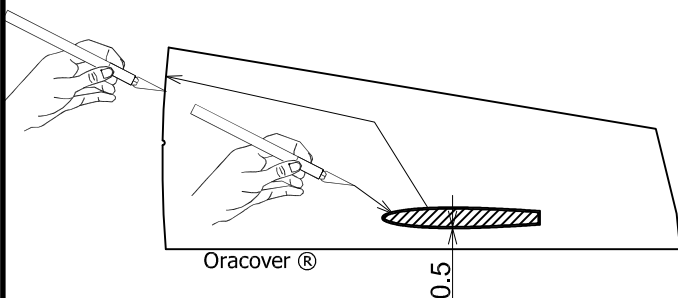

Olympic

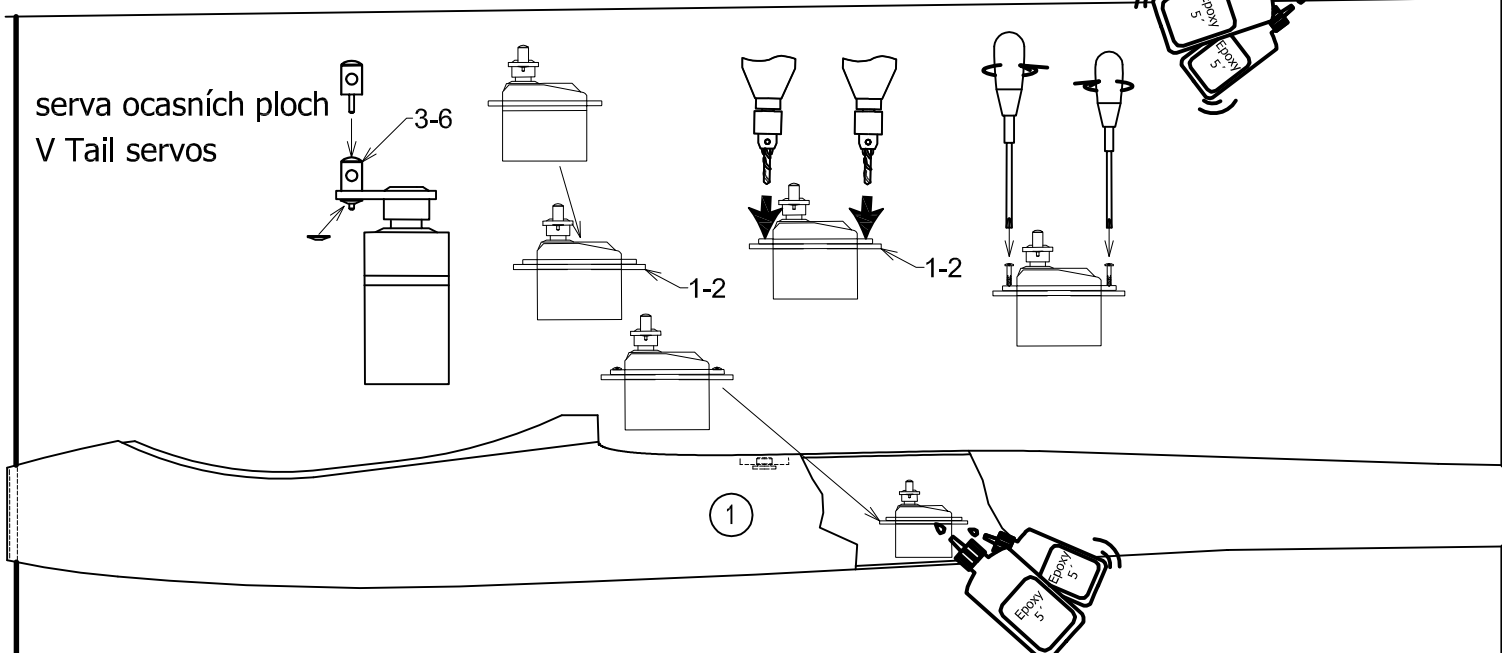
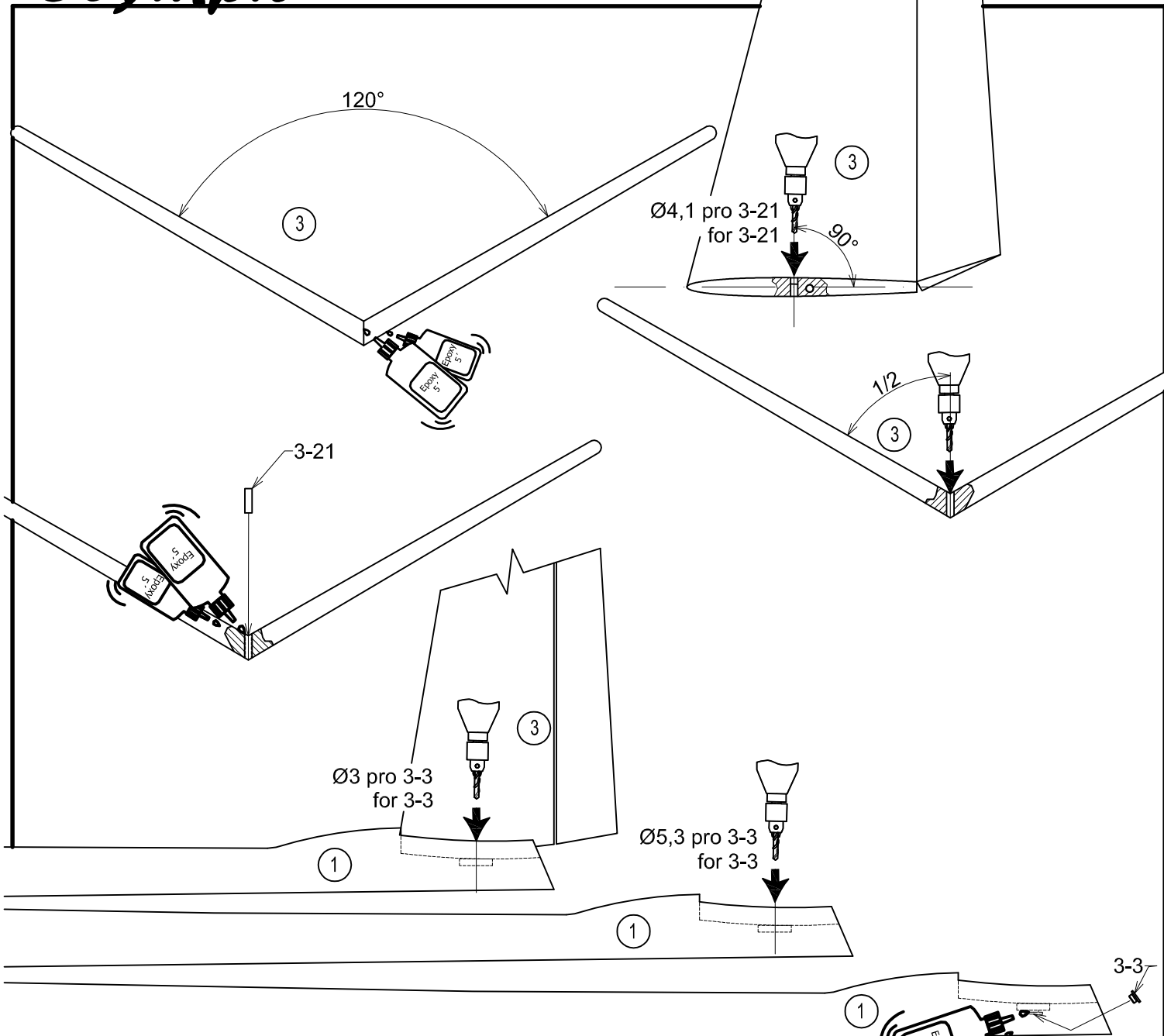

Olympic

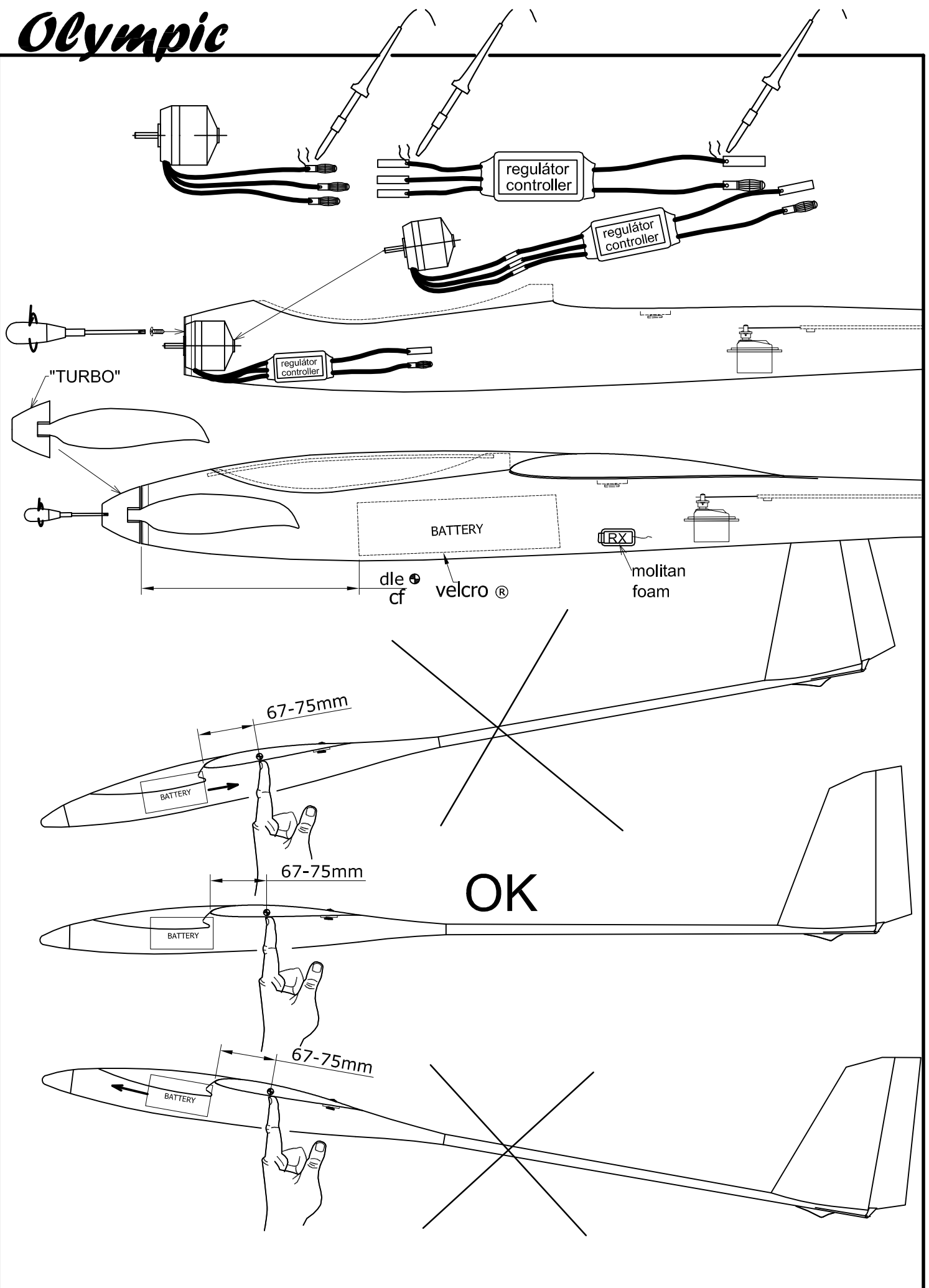

Olympic

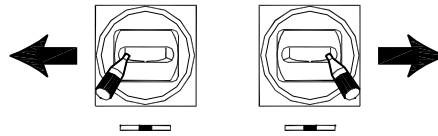
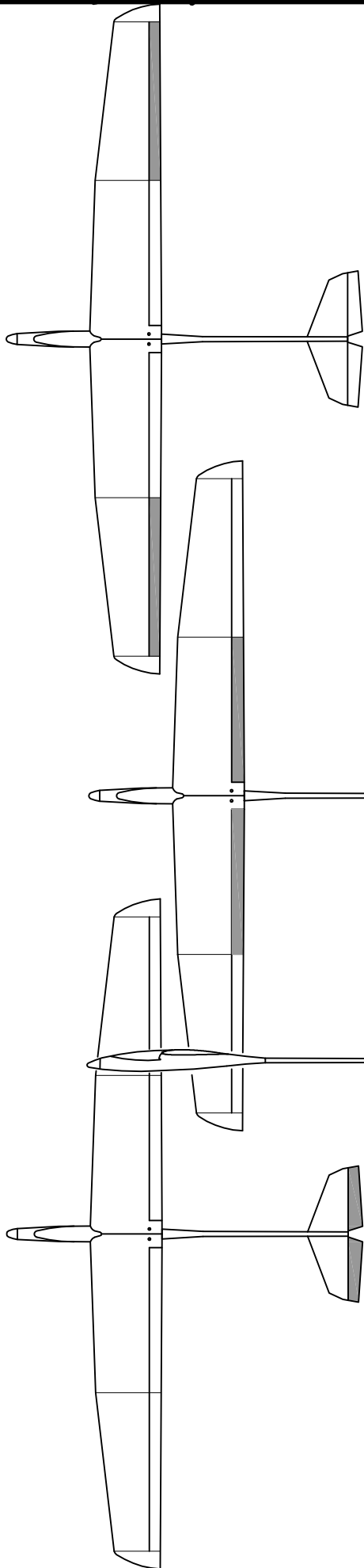

↑ Přistání - 9 - 12 mm
Landing

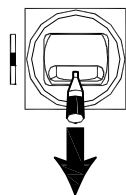
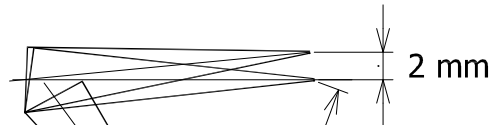
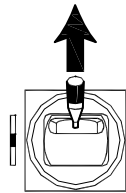
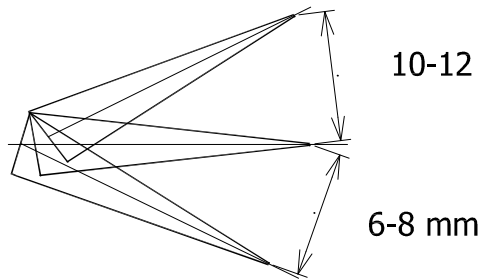

5 mm - thermik
35 mm - přistání
Landing

